

**CORTE - CC**

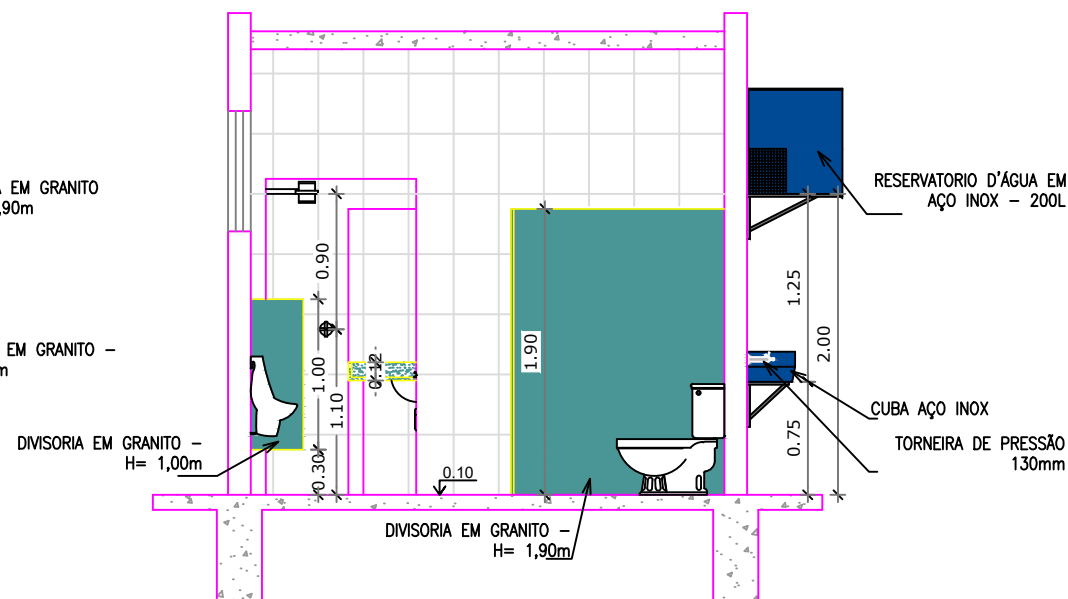

**CORTE - DD**

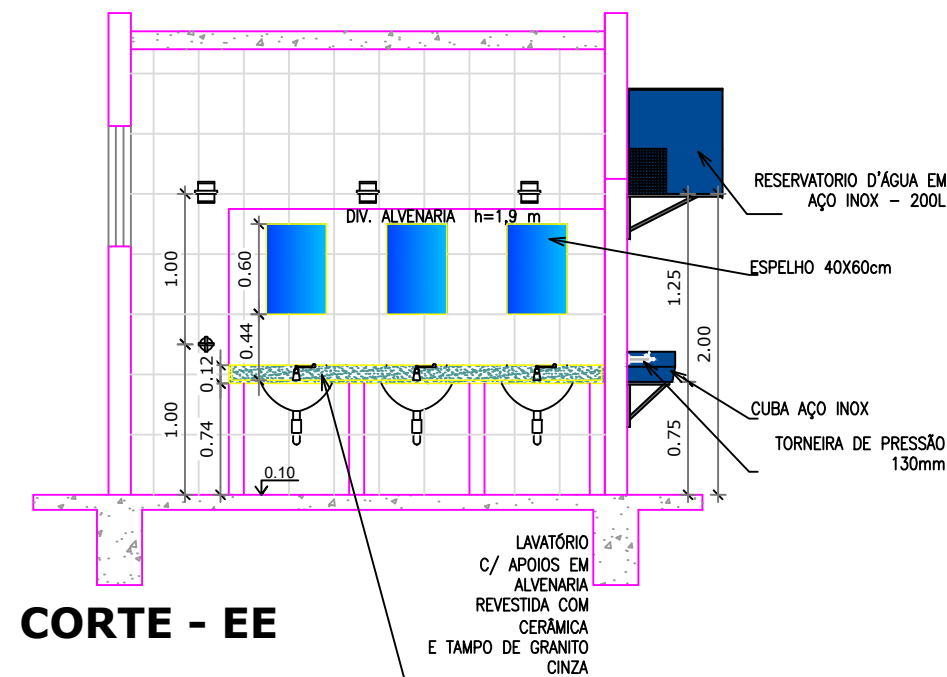

**CORTE - EE**

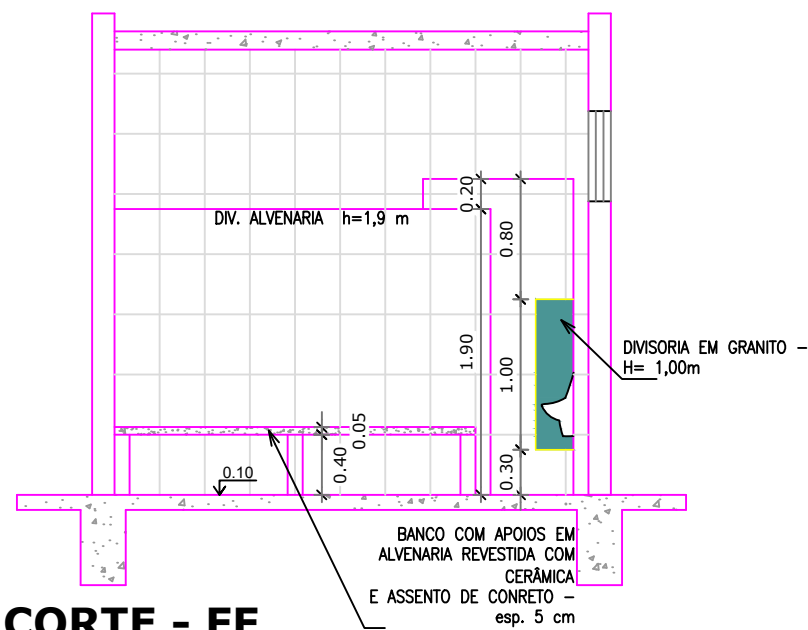

**CORTE - FF**

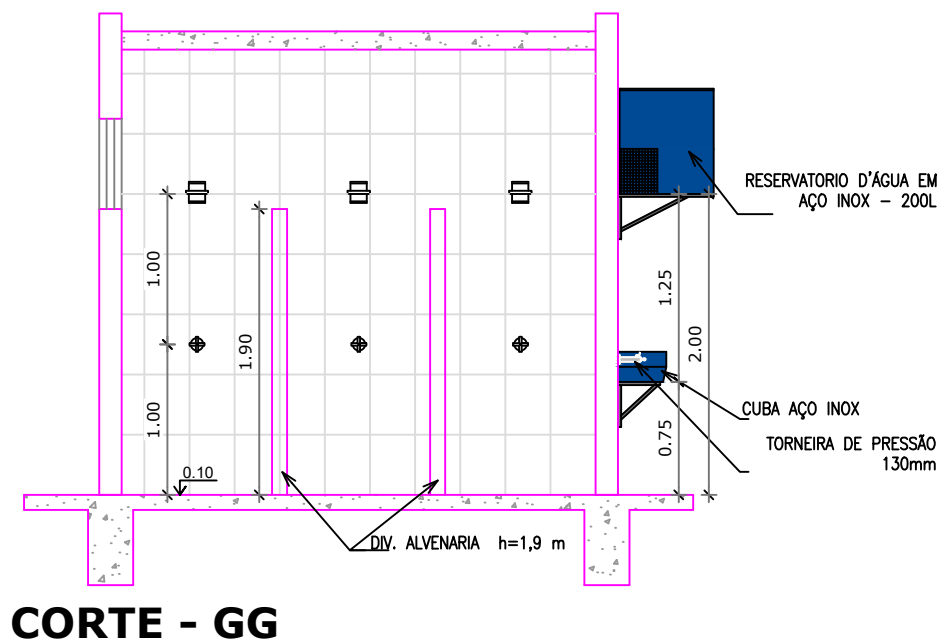

**CORTE - GG**



PREFEITURA MUNICIPAL DE  
**VÁRZEA GRANDE**  
*amar • cuidar • acreditar*

**PREFEITURA MUNICIPAL DE VÁRZEA GRANDE**

LOCALIZAÇÃO: ANTÔNIO SOTÉRO DE ALMEIDA  
Av. Julião de Brito, Parque do Lago, 78070-200.  
Várzea Grande

ASSUNTO:

**CORTES**

DATA:

**JAN/2019**

UNIDADE:

**Metro**

ESCALA:

PROJETO:

**ARQUITETÔNICO**

AUTOR DO PROJETO:

**LUAN BRENO ZANOLLO MILANI**  
ENGENHEIRO CIVIL CREA-MT 040706

**3/6**